

## BOOKING PLACE

Name ..... First name .....  
 Address .....  
 Post code ..... Country .....  
 Phone ..... Fax .....  
 E-mail .....

I WISH TO RENT A PLACE FOR A STAY

From ..... at 3 pm to ..... at 12 pm

TENT     CARAVAN     CAMPING CAR

Package ..... =

Additional adult (7 years and +) ..... x  =

Additional child (2 to 6 years) ..... x  =

Pet ..... x € 3,70 =

Electric installation ..... x € 3,60 =

TOTAL of the daily stay =

Number of nights =

TOTAL OF THE STAY CAMPSITE =

Deposit to turn us this day ..... =  € 15

Tourist Tax 0,55 €/+18years/Night

The balance will be paid the day of your arrival.

I declare to have acquainted with the conditions as well as the price lists and to accept them.

Place ..... date .....

Signature :

## RESERVATION SPECIFIC CONDITIONS

All our accommodations specify a name and cannot be resold or sublet. The agreement will only become effective on receipt of the reservation form duly signed by the tenant and the deposit of 25% of the total amount. The balance outstanding should be paid the arrival date.

A Contract will then be sent to you for confirmation of your reservation.

### Camping-Caravanning Site

A deposit for € 15 must be paid in advance. The deposit can be paid with cash, or credit card, with the number and the date of expiration. The dates of the reservations must be adhered. Your site can be reserved from 3 pm till 8 pm at the date required (arriving after 8 pm can not guarantes). In cas of problem please contact us. If you wish to cancel, notify your office whithin 30 days before the arrival, by letter or fax. After 30 days no deposit is refundable.

### Mobil home 5/6 persons and Coco Sweet

Arrival From 3 pm and departure before 10 am.

A deposit of 25% of the total amount must be paid.

### Inventory of fixtures

An inventory of fixtures will be made at each tenant's departure. This will have to control and mention anomalies on the day of arrival.

A guarantee will be asked for at the arrival date. This sum will be integrally reimbursed the day of departure if the accommodation is returned in accordance with the initial inventory.

### Reception

The reception opening hours are from 9 am to 12 pm and from 3 pm to 6 pm. For arrivals outside opening hours contact us at 01 64 45 87 79.

### Cancellation

Should the tenant have to cancel his stay for the following reasons : serious disease, parents' accident or death, economic redundancy, he would have to transmit to us as soon as possible medical certificate, hospitalisation bulletin, death certificate. On receipt of written proof, the Directors will reimburse the deposit to the tenant (except registration fees).

### Pets

Pets are allowed on the camping site if elementary hygiene rules are respected. They should not be left alone in or around the accommodation. They have to be vaccinated and kept on a lead. Breeds of dogs submitted to a specific regulation will not be allowed on the camping site.

### TVA

All prices are VAT-inclusive at a rate of 10% applicable on the date on which the preices were calaculated. Any subsequent changes in the VAT rate applicable occurring between when the prices were calculated and the holiday being invoiced will lead to a modification of the corresponding VAT-inclusive price, which the client accepts unreservedly.

### Litigation

To resolve any dispute, please first contact customer service at the office. If your concern is not resolved, you have the option to request mediation via Medicys consumer services, provided that you do so within one year of the date you submitted a written copy of your complain to us, with return receipt and signature confirmation.

R.C. MELUN 309 495 158 - APE 5530Z - SARL Daugeron caravanning au capital de 38340 € - FR 31 309 495 158 00011  
 Siège social : LA GENEVRAYE 77690 - Classement Atout France 19/04/17 N°C77-019546-002, 3 étoiles Loisirs pour 175  
 emplacements dont 145 emplacements «grand confort caravane», 7 emplacements dans l'aire de stationnement pour  
 autocaravanes et 30 emplacements «confort caravane» et «grand confort caravane»

## CAMPSITE

*Le Parc du Gué*  
 Caravanning et hôtellerie de plein air ★★★

# PRICES 2018

OPEN FROM MARCH 15<sup>th</sup> TO NOVEMBER 30<sup>th</sup>

### Services

- Water, electricity
- Children playground
- Fishing
- Bathrooms : Showers, toilets, wash-up sinks, washing machine...
- Pets welcomed (see conditions)
- 1 car parking place on each place (2nd car on interior parking)

### CAMPER - CARAVANNER - CAMPING CAR 2017

Per night	Before 29/06 or after 31/08	From 29/06 to 31/08
2 persons fixed pricew	€ 13,50	€ 17,00
Camping-car (electricity + sewage disposal)	€ 17,00	€ 19,90
Hiker fixed price (1 pers.)	€ 11,00	€ 13,00
Additional adult (7 years and +)	€ 5,50	€ 7,00
Additional child (2 to 6 years)	€ 3,60	€ 4,30
Electric installation	€ 3,60	€ 3,60
Pet	€ 3,70	€ 3,70
Additional vehicle	€ 5,30	€ 5,30

COYTE COMPAGNIE • La Roche sur Yon • 02 51 05 08 43 • Imprimé sur papier recyclé • Plans et photos non contractuels • Sous réserve d'erreurs typographiques • Ne pas jeter sur la voie publique.

Le Parc du Gué - DAUGERON CARAVANNING S.A.R.L.

Rue Cahen Michel - 77690 La Genevraye

Tél. : 01 64 45 87 79 - Fax : 01 64 78 31 46

contact@camping-parcdugue.com - www.camping-parcdugue.com

	before 29/06 or after 31/08		From 29/06 to 31/08	
Cocosweet (4 pers.)	40 € / Night		45 € / Night	
Forfait Mobile-home Florès + Galaxie	1 or 2 pers.	+ 2 pers.	1 or 2 pers.	+ 2 pers.
Package Week-end (from friday 6 pm to sunday 6 pm)	140€	160€	-	-
Package Mid-Week (from monday 15 pm to friday noon)	180€	215€	-	-
Special Week ends (3 nights) Easter, Pentecost	245€	285€	-	-
Special Week ends (4 nights) Ascension, 1 <sup>st</sup> May and 8 May	265€	305€	-	-
Package 2 nights during the week	140€	155€	-	-
Package 7 nights	325€	375€	425€	445€
Package 14 nights	580€	640€	740€	780€
Additional night (possible on request)	27€	34€	-	-
Animal (par nuit)	5,15€	5,15€	5,15€	5,15€

Of 29/06 in arrival 31/08 and allocates Saturday • Arrived after 15 hours and allocates before 10 am for fixed prices at 2, 7 and 14 nights.

**COCO SWEET 4 PERS. (0 - 7 years)**



**MOBIL HOME GALAXIE 5/6 PERS. (0 - 7 years)**

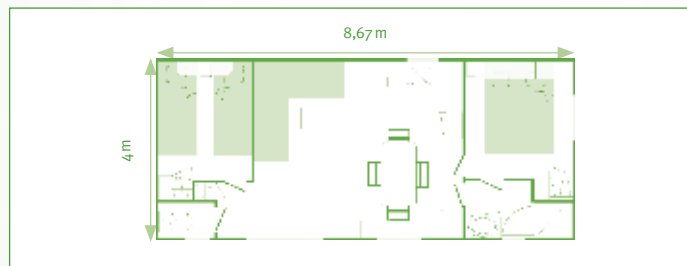

**MOBIL HOME SUPER MERCURE 5/6 PERS. (0 - 7 years)**

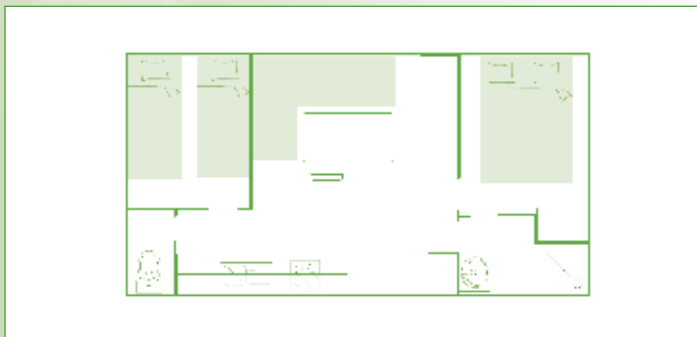

**DESCRIPTION OF COCO SWEET**



1 bedroom: 1 bed 140 x 190 cm and a lounge with 2 convertible sofas. Equipped kitchen corner (tableware, microwave, fridge), without bathroom and WC. TV. Duvets and pillows provided. Sheets not provided

**DESCRIPTION OF THE ACCOMMODATIONS**

Situated on privileged places, with an unimpeded outlook over the lake, our mobile-homes are completely equipped :

1 bedroom : 1 double bed 140 x 190 • 1 bedroom : 2 single beds 80 x 190 • Sheets and towels not provided • Kitchen : 4 ring gas cooker, refrigerator, crockery and kitchen utensils • Dining area • TV • Shower-room : Shower, washbasin, toilets • Garden furniture, barbecue.

Option cleaning service of the end of stay : € 28

Name ..... First name .....  
 Address .....  
 Post code ..... Country .....  
 Phone ..... Fax .....  
 E-mail .....

**I WISH TO RENT A ACCOMMODATION FOR A STAY**

From ..... at ...h to ..... at ...h

Subject to mobile home available.

TENTE COCO SWEET  MOBIL-HOME MERCURE  MOBIL-HOME GALAXIE

**IDENTIFICATION OF THE PERSONS LIVING IN THE ACCOMMODATION**

Name	Firstname	Date of birth

Package ..... =

Additional night (possible on request) ..... =

Pet (for one night) ..... € 5,15 =

TOTAL OF THE STAY CAMPSITE =

Deposit to turn us this day (25% of the stay)

Tourist Tax 0,55 €/+18years/Night

The balance will be to paid the day of your arrival.  
 A deposit of € 75 will be asked you at your arrival.

I declare to have acquainted with the conditions as well as the price lists and to accept them.

Place ..... date .....

Signature :

